

PLAN SHOWING THE PRO. CONSTN. OF RESIDENTIAL BUILDING IN TS.NO.394/1pt,

KODAMBAKKAM VILLAGE, AT PLOT NO. 122, 6th STREET, 1st SECTOR, KK-NAGAR, CHENNAI

SCHEMATIC plan
ZONE 9 DIVISION 130
SCALE 1" TO 8'0"

SPECIFICATION A1x05
 * FOUNDATION IN R.C.C 1:2:4 MIX WITH NECESSARY REINFORCEMENTS OVER P.C.C & SAND FILLING.
 * BRICKWORK IN CM 1:5 MIX USING STOCK BRICKS.
 * ALL R.C.C WORKS ARE IN 1:2:4 MIX WITH REINFORCEMENTS.
 * FLOORING CONCRETE 1:4:8 MIX FINISHED WITH CERAMIC TILES JOINTERS ARE IN TEAKWOOD.

JOINERY

TYPE	DESCRIPTION	SIZE
MD	DOOR	3'6"X7'0" 1006x2134
D1	"	3'0"X7'0" 915x2134
D2	"	2'6"X7'0" 762x2134
W	"	4'0"X4'6" 1220x1372
V	VENTILATOR	3'0"X2'0" 915x610

AREA STATEMENT

DESCRIPTION	SQ.FT	SQ.M
PLOT AREA	2400	222.96
GROUND FLOOR	855	79.42
STILT FLOOR	495	45.99
FIRST FLOOR	1553	144.30
SECOND FLOOR	688	63.95
TOTAL		287.67
COV. 64.72%	1.29	

COLOR CODE

PROPOSAL:

ROAD:

BOUNDARY:

OWNER'S SIGNATURE:

S. ATHIYANAN, B.E.
 CHAR. ENGR. ENGINEER,
 Class I.L. catsec Surveyor No. 183
 Corporation of Chennai
 8, Nethalathi Street, T. Nagar,
 Chennai-17, Pin: 28156824,
 Mobile: 91038440,
 LICENSED SURVEYOR

Inspection plan

X The existing building not yet demolished
 X proposed Const. work commenced
 X Site Boundry: 21'0" wide
 Public road (Crossed)
 St Right
 X Drainage
 8.5m
 10/9/05

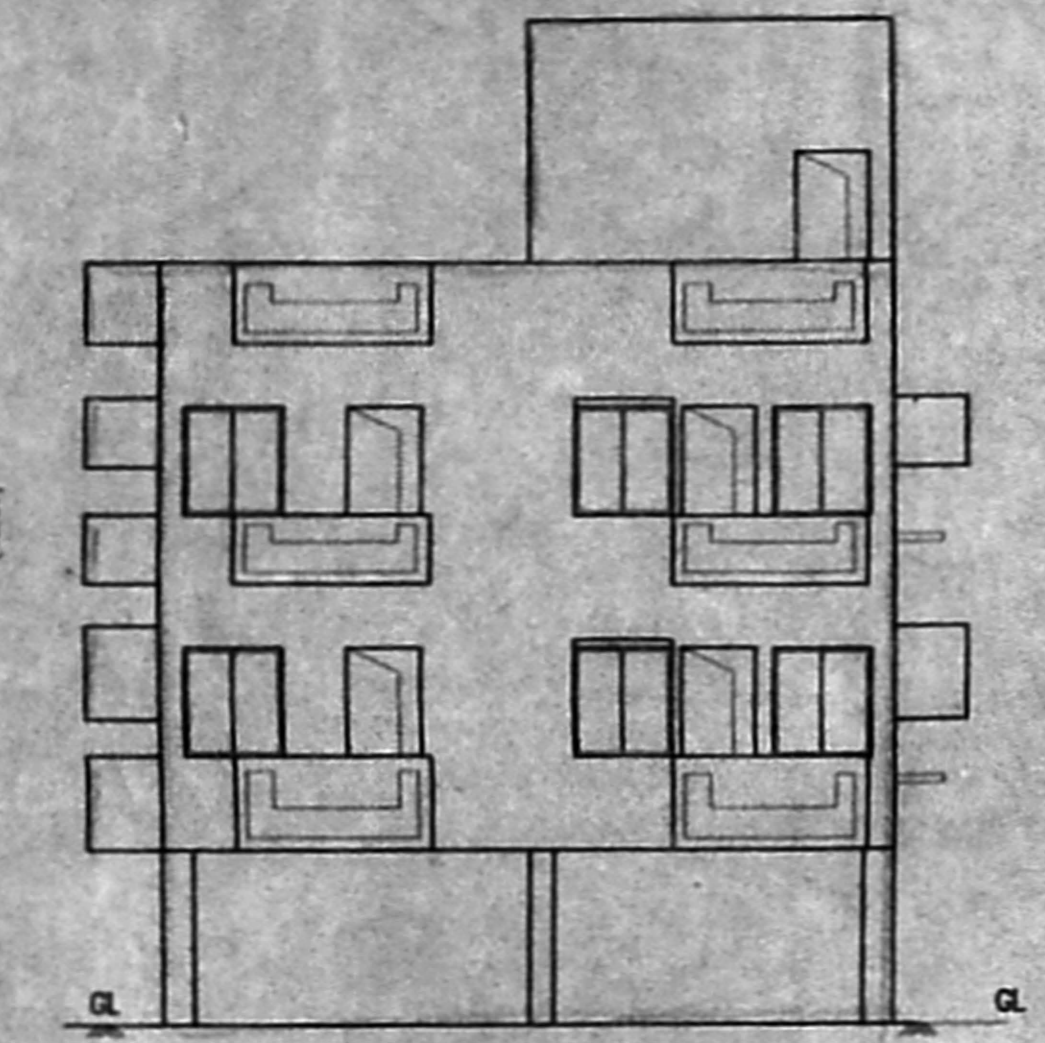

ELEVATION

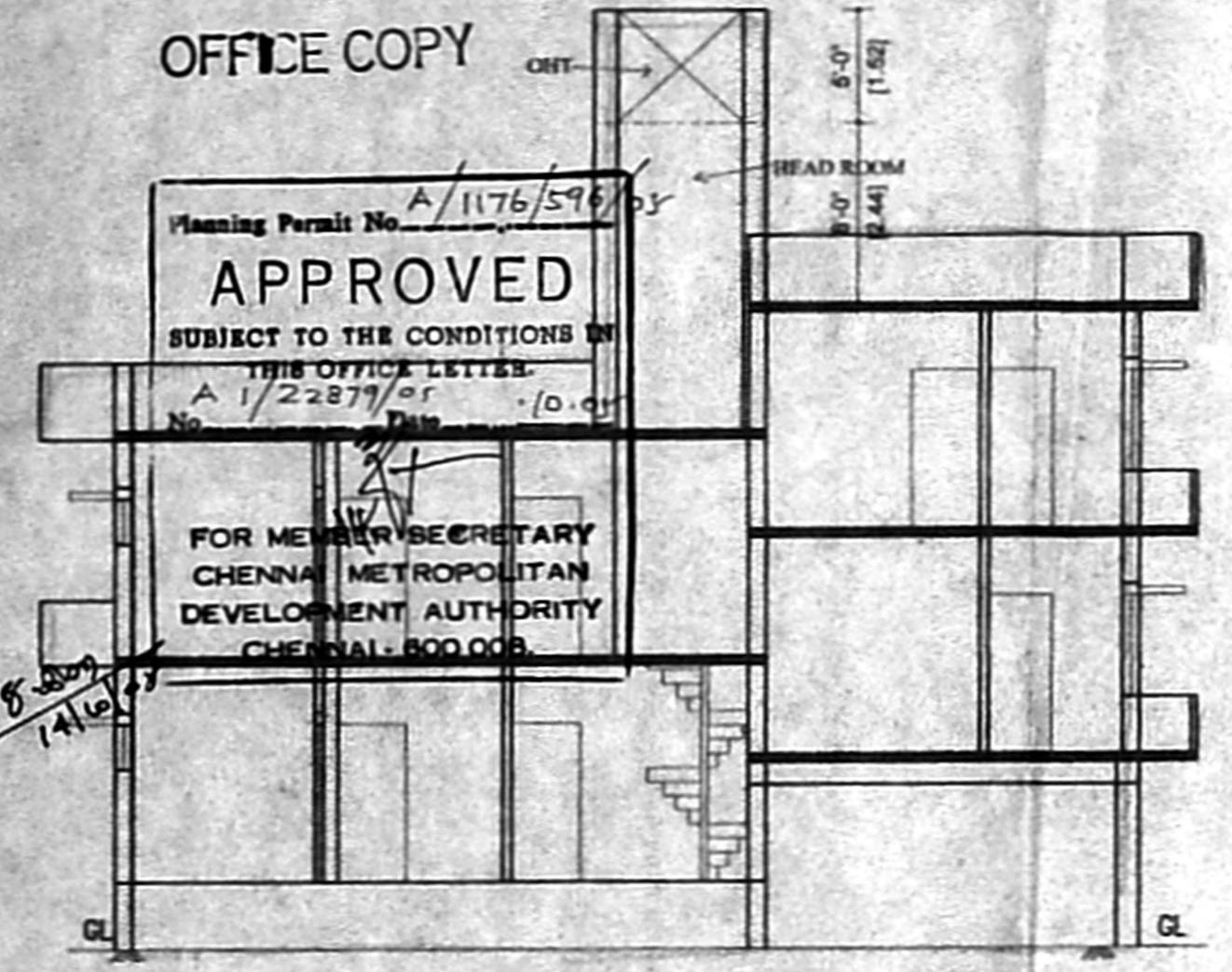

SECTION ON CC

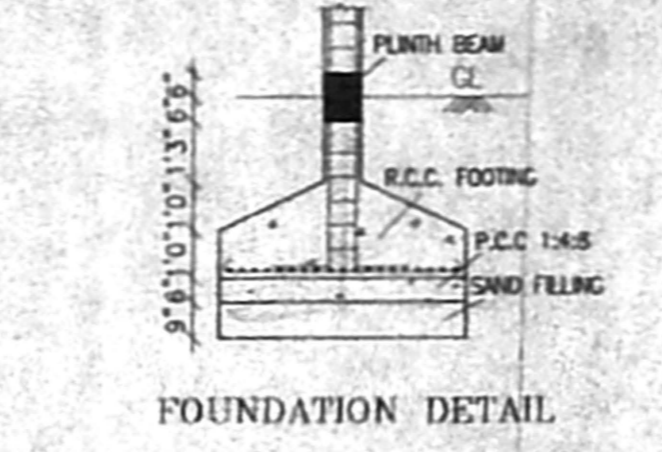

FOUNDATION DETAIL

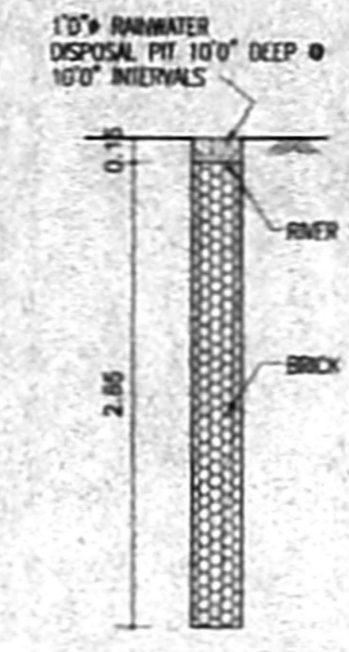

PERCOLATION PIT

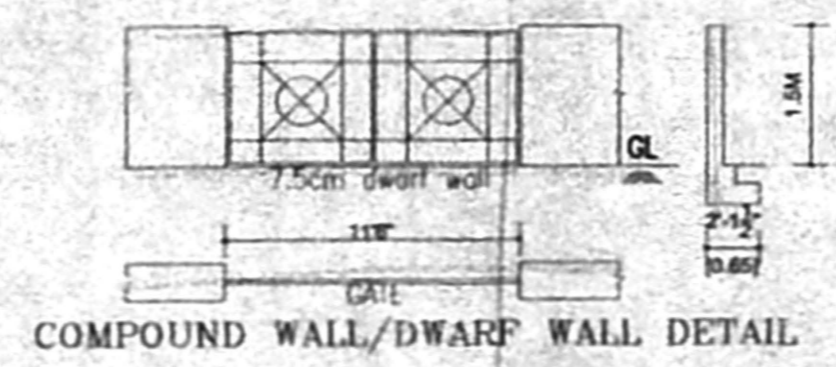

COMPOUND WALL/DWARF WALL DETAIL

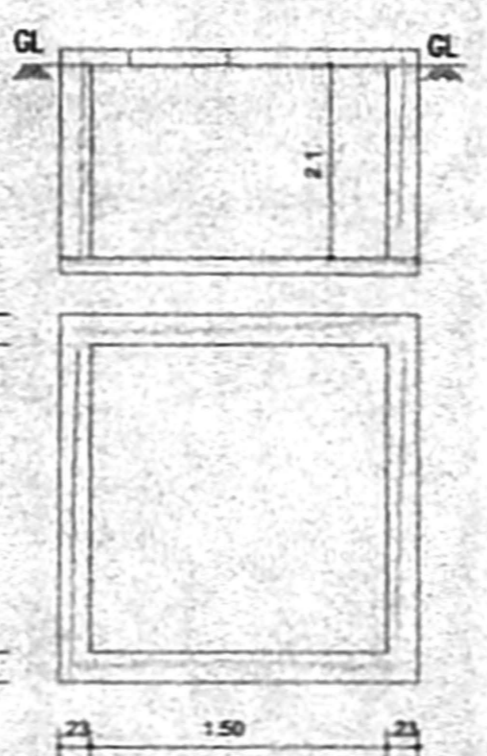

SUMP DETAIL

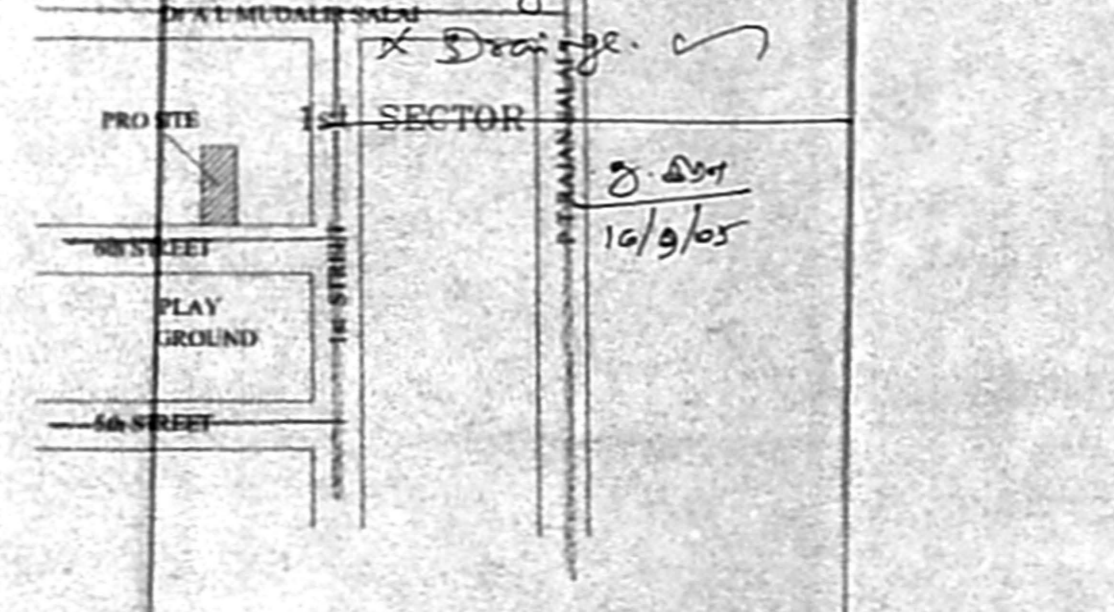

KEY PLAN NOT TO SCALE

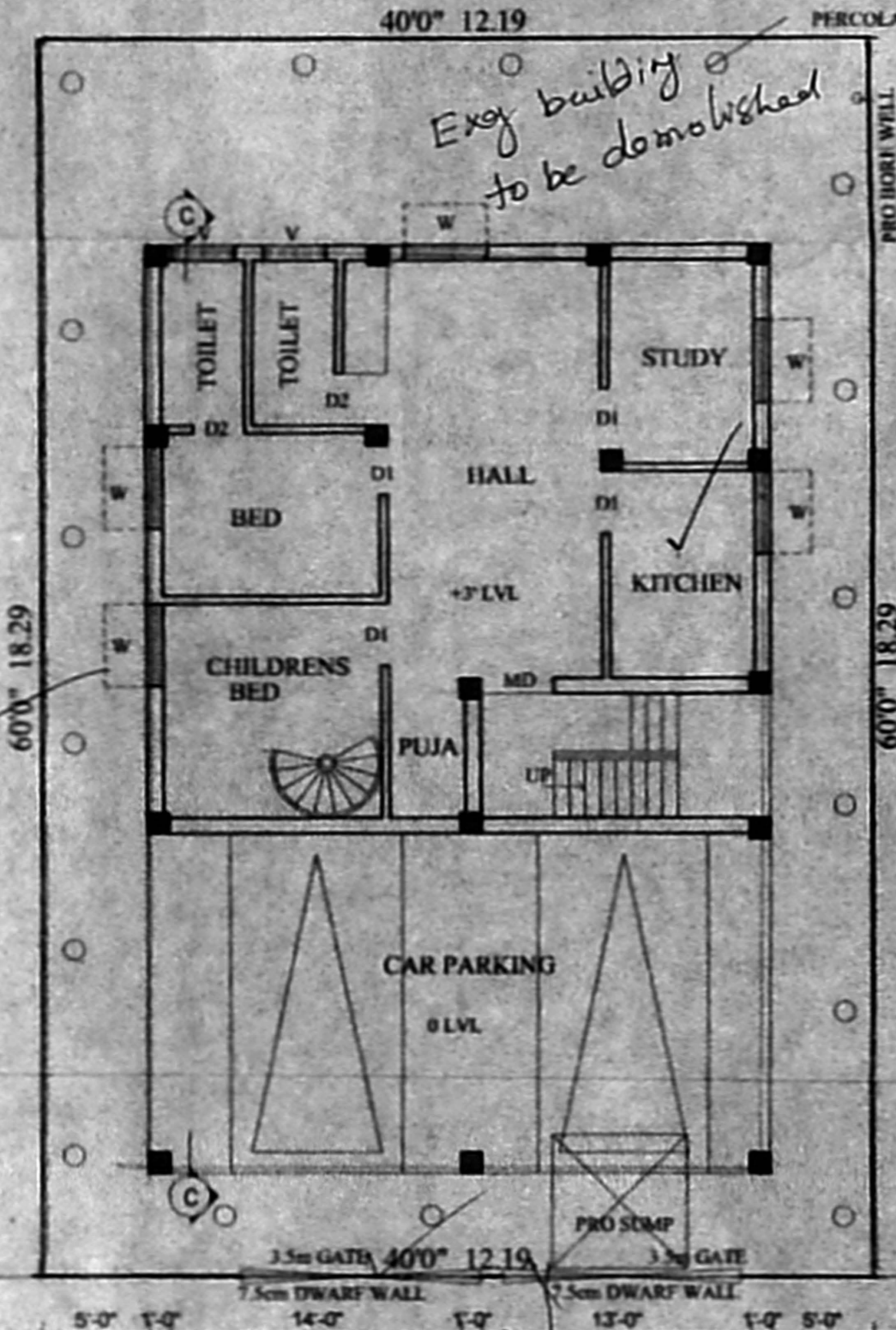
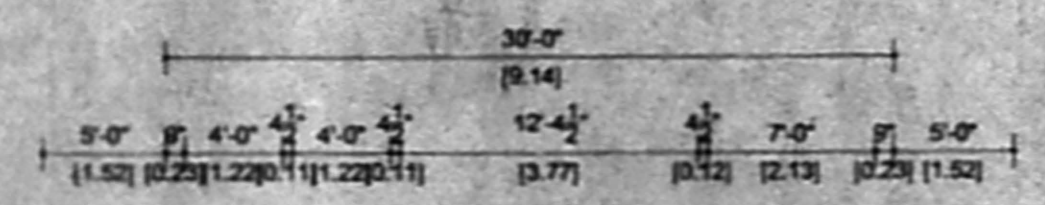

SITE/GROUND /STILT/FLOOR PLAN

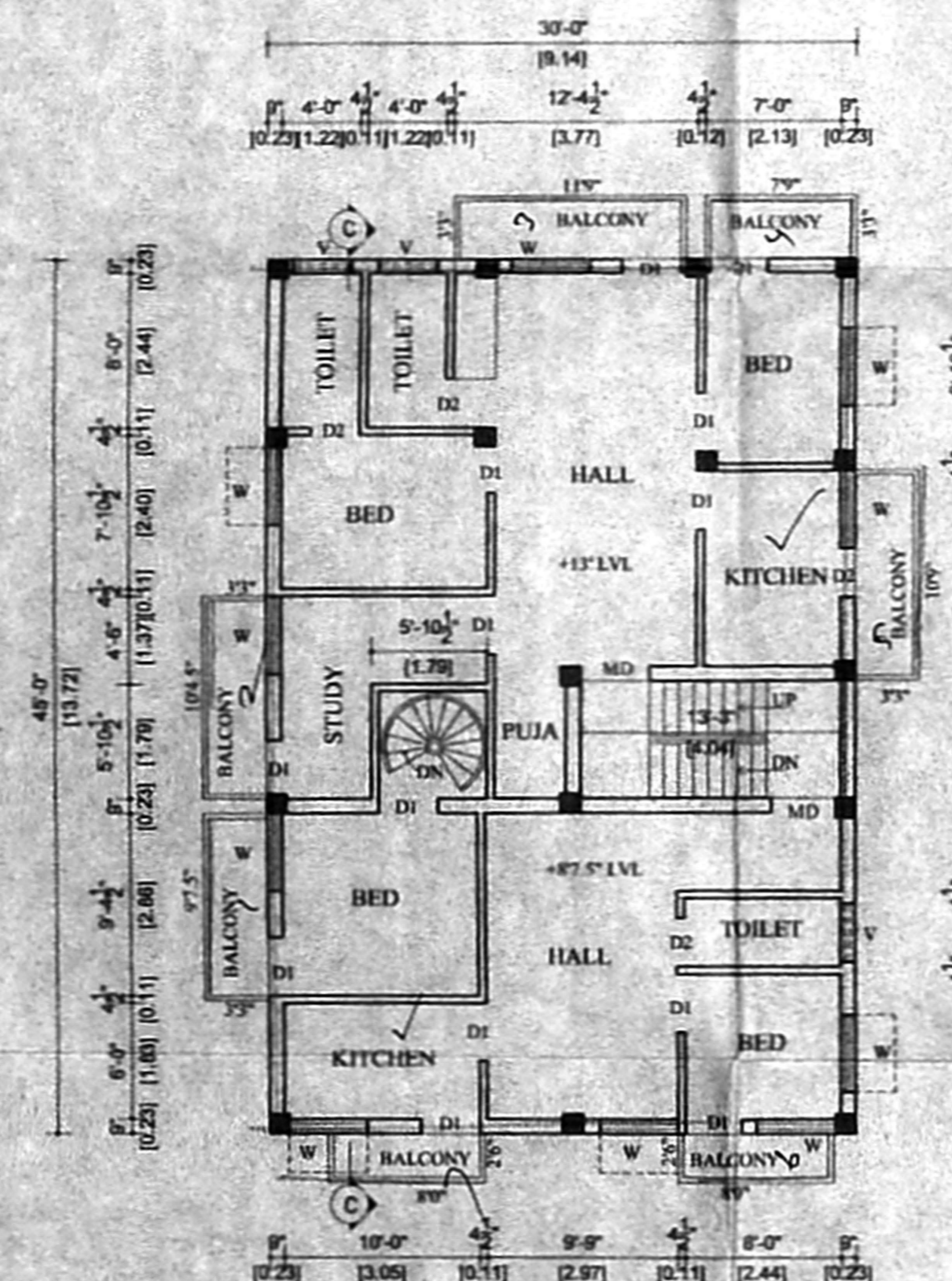

FIRST FLOOR PLAN

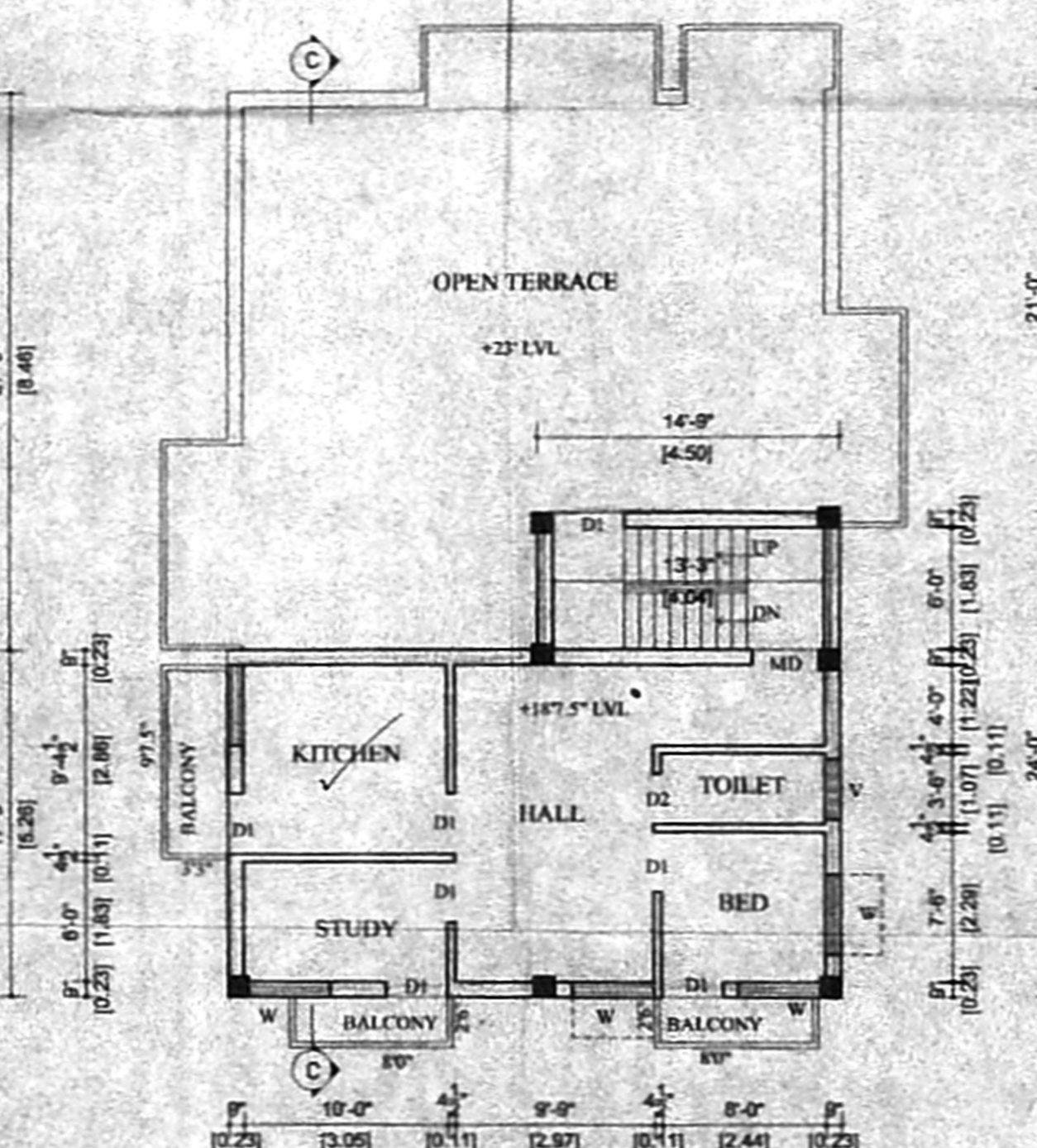

SECOND FLOOR PLAN PART

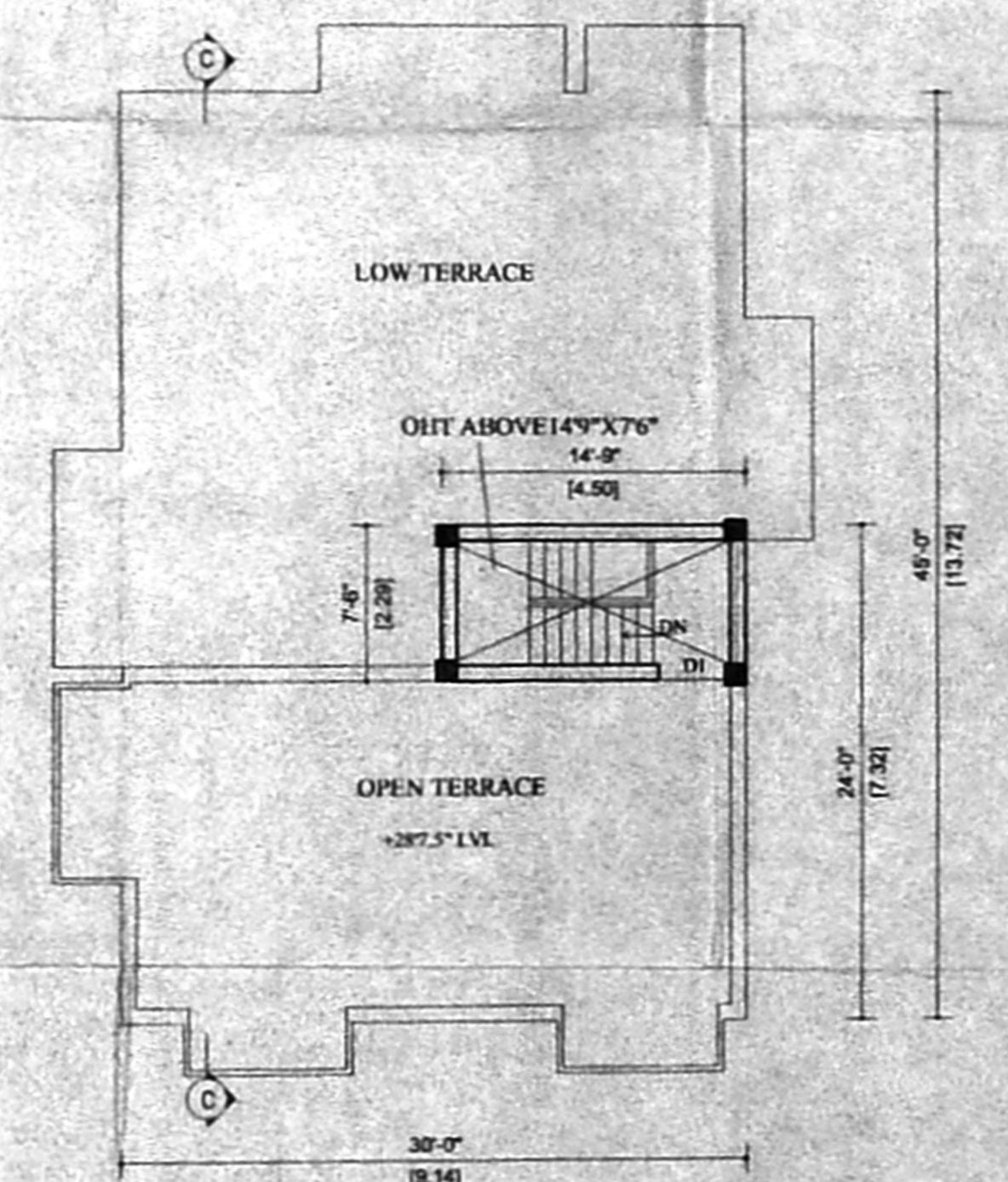

TERRACE FLOOR PLAN